



2-way Type T (thermostatic) coaxial floor-mount tub filler with hand shower

**MZ39XX**



## Specifications

### Descriptions

- 1-jet hand shower
- 1/2" inlet male NPT
- Thermostatic coaxial cartridge with check valves
- 2 check valves
- 2 parts: rough and trim
- Drilling hole diameter = 2 1/2 (63mm)

### Available colors

- C : Chrome

### Available flow

- 23 L/min, 6.0 gpm (US) 60psi

### Cartridge

- 0939

### Certifications

- CSA B125.1
- ASME A112.18.1
- ASSE 1016
- CMR248 Approval
- ADA

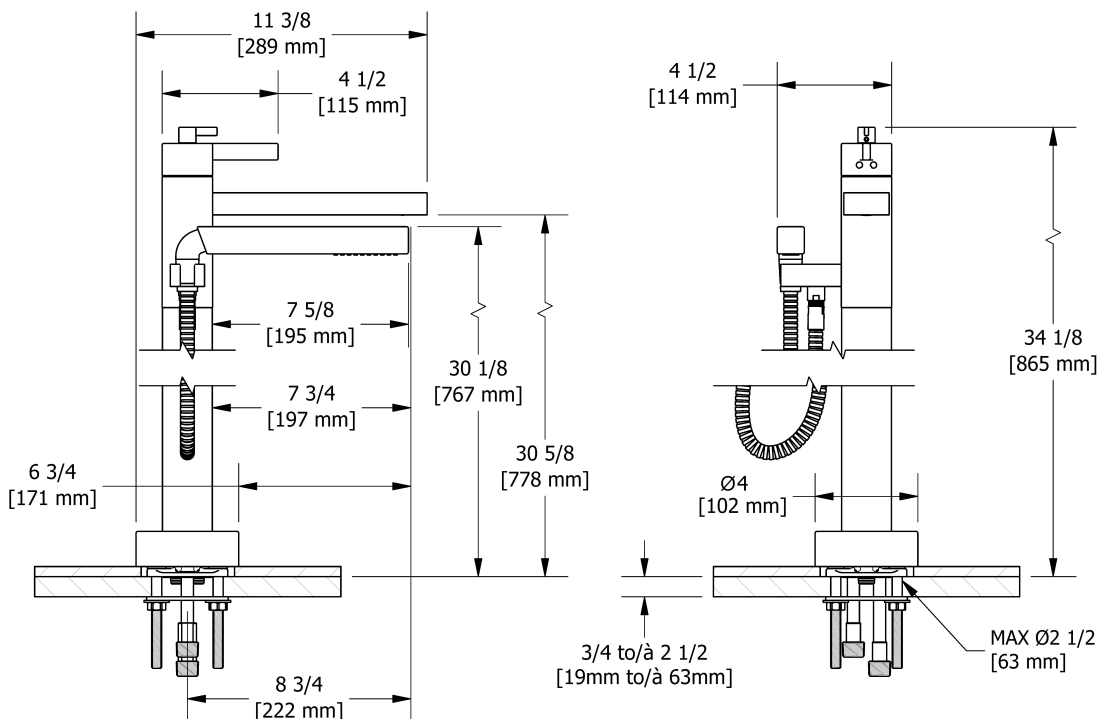

Sizes, models and finishes may differ from those presented.

### Warranty

This Riobel Inc. product you have purchased carries a **Limited lifetime warranty on the chrome, PVD finished and all working parts** and is guaranteed from the initial purchase date against all **manufacturing defects**. All other finishes including plastic component are guaranteed for one year. All electric and/or electronic parts are covered by a 1-year limited warranty.

### Customer Service

Ontario, West Canada : 888-287-5354 Quebec, Maritimes, United States : 866-473-8442

2017.03.27